

Courses & distances from A wo. to Pine seven lines

- 1. N 20 E 20 Beech
- 2. N 47 E 16 Sugar tree
- 3. N 12 E 10 Post
- 4. N 60 E 10 Post
- 5. N 75 E 16 Post
- 6. N 39 E 16 Post
- 7. N 77 E 12 Pine

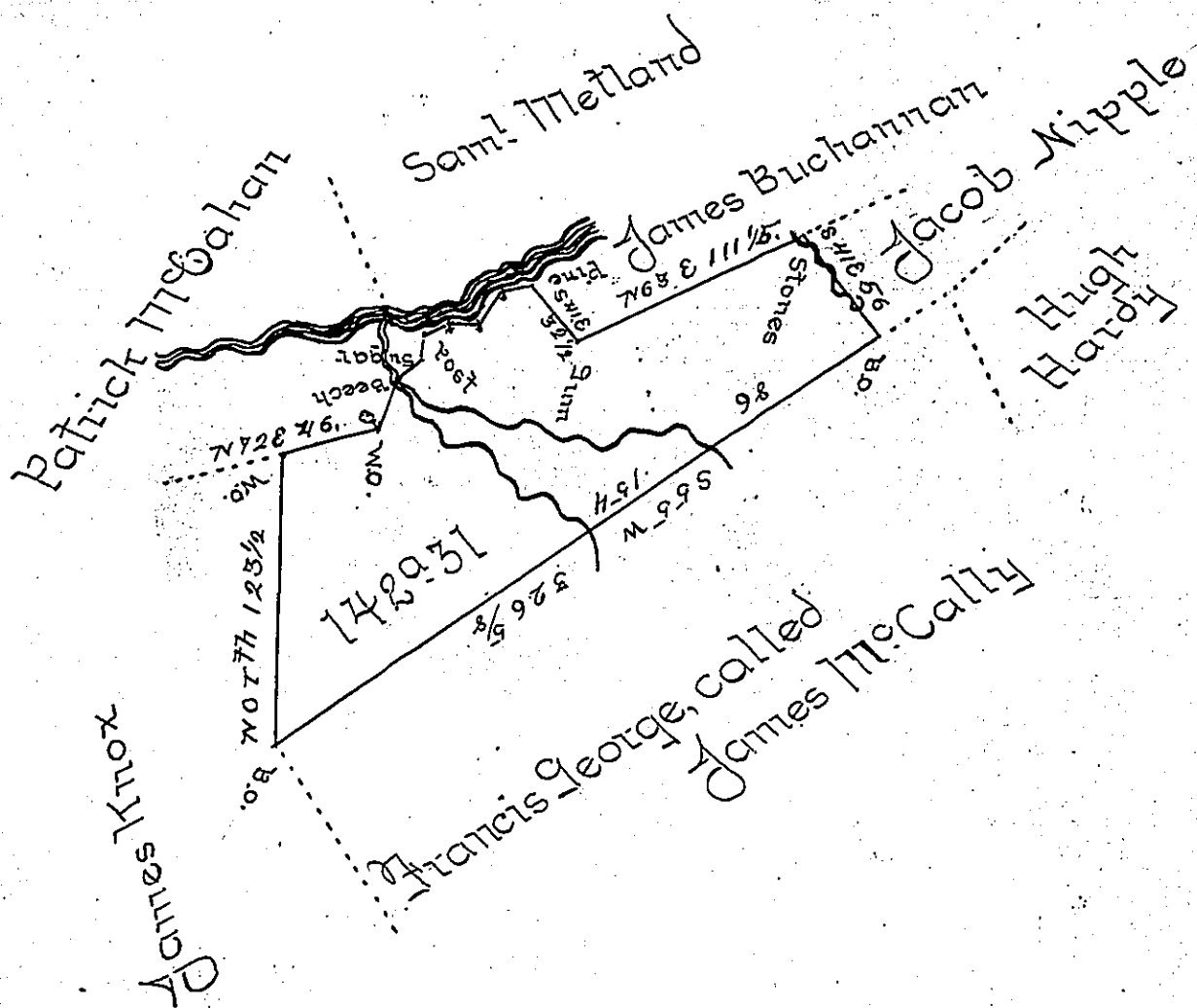

Draft of one hundred and forty two acres and thirty one perches of land with six per Cent for Raads situate in Millford town-ship in Millflin county surveyed 26th August 1814 in pursu-ance of a Warrant to Richard Gilliland dated 26th May 1814. Note, improvement at time of survey, two houses or Cabbins with Warrantes & family living in one of them & near three acres of the land in a state of cultivation

Michael M Monahan

To Richard D Beech Esquire }
 Surveyor General of Pennsylvania }

IN TESTIMONY that the above is a copy of the original remaining on file in the Department of Internal Affairs of Pennsylvania, made conformably to an Act of Assembly approved the 16th day of February, 1833, I have hereunto set my Hand and caused the Seal of said Department to be affixed at Harrisburg,

this fifth day of June 1900

James W. Latta
 Secretary of Internal Affairs